

# Modello EP (struttura a C)

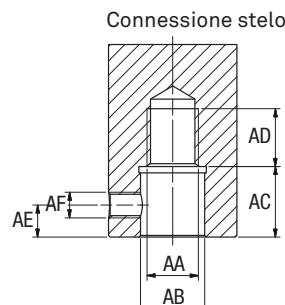
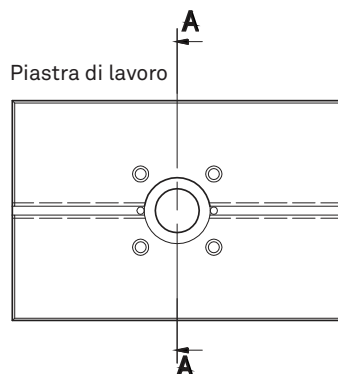
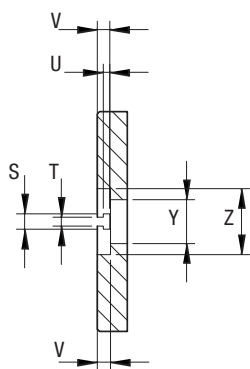
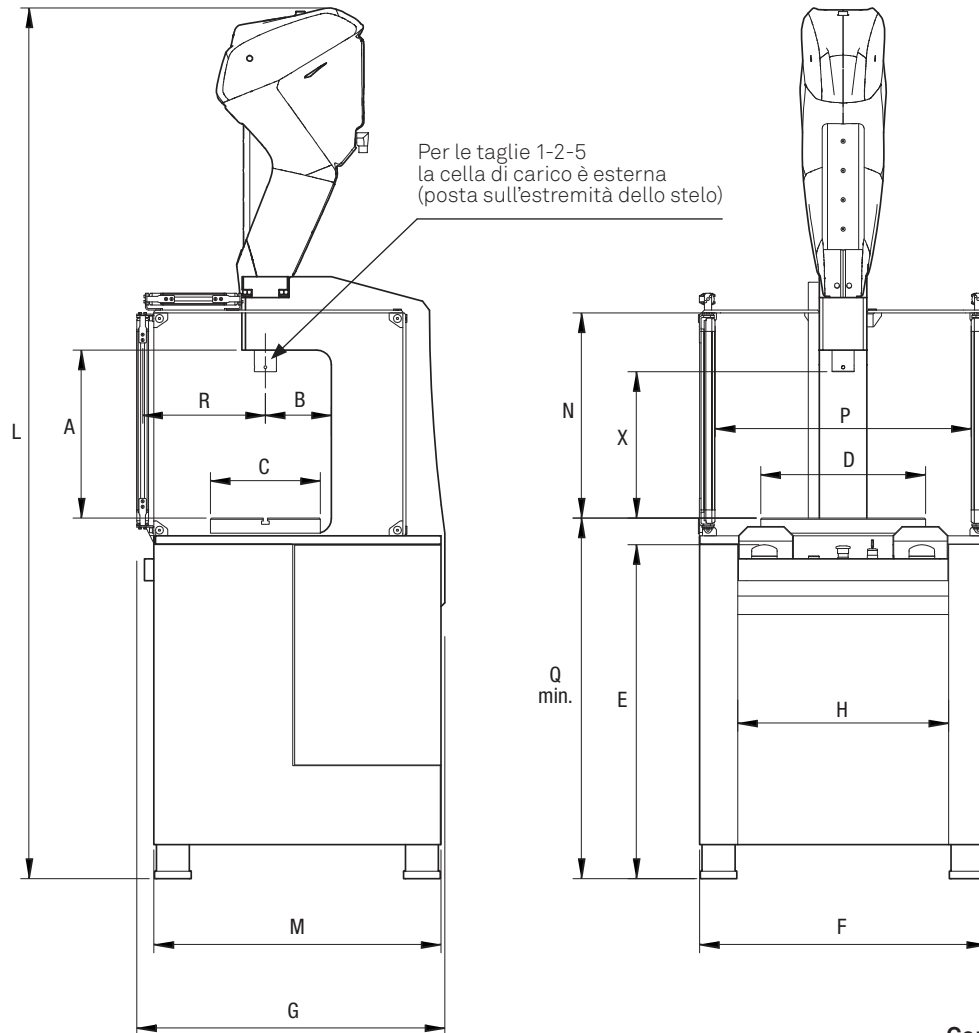

## Connessione stelo standard

	EP 10-25	EP 50-100
AA	M16x1,5-6H	M20x1,5-6H
AB	Ø20 H8	Ø25 H8
AC	22	28
AD	18	22
AE	10	12
AF	M8x1,25-6H	M8x1,25-6H

## Connessione stelo con cella di carico esterna

	EP 1-2-5-10-25	EP 50-100
AA	M12x1,5-6H	M20x1,5-6H
AB	Ø16 H8	Ø25 H8
AC	18	28
AD	15	22
AE	8	12
AF	M6x1-6H	M8x1,25-6H

	A	B	C	D	E	F	G	H	L	M	N	P	Q	R	S	T	U	V	X(A)*	X(B)*	Y	Z(H7)
EP 1-2-5	325	120	200	300	900	784	840	576	1893	784	370	700	984	340	21	12	9	17	/	230	40	60
EP 10-25	394	150	250	350	900	784	840	576	2268	784	478	700	984	340	21	12	9	17	360	289	50	70
EP 50-70-100	459	180	300	450	900	784	840	576	2268	784	478	700	984	340	21	12	9	17	400	315	50	70

\*X(A) standard - \*X(B) con cella di carico esterna